

Lutheran
Summer

Music

The National Lutheran
High School Music Camp

June 22
to July 20

1997



*An affordable, comprehensive camp for
talented high school students*

Lutheran SUMMER MUSIC



Take Time for Music this Summer



Expand your repertoire
in private lessons with artist teachers



Perform masterworks
with distinguished conductors in
orchestra, band, or choir



Develop teamwork
in a small vocal or instrumental ensemble



Experience worship
that involves you in a living tradition



Enjoy social and recreational times
in varied activities with new friends



Preview life on a college campus
with modern facilities in a beautiful setting

Take Time for Lutheran Summer Music
-- Musical Excellence in a Caring Christian Community!





Dear Parents and Students,

Music, we have discovered, is a gift we want and need to give each other. You have the opportunity to receive and give that gift again at Lutheran Summer Music. LSM is a unique opportunity for personal and musical growth. We combine Christian care and joyous worship with high musical standards to nurture each student's special gifts. Friendships happen along with the music. Our counselors, each one an experienced musician-educator, care for each student personally. All of us gather daily for worship, sharing life, joy, hope, and challenge in a community of faith.

We also have lots of fun, from social events to July 4th observances to dorm parties. Add to that the shared experience of an excursion (our "caravan") to a major arts center. All that is the stuff of memories. Be sure to bring your camera!

At LSM students become aware of that other great caring community, our friends who provide scholarships. Christian people across the land want the best for students and generously support our work.

Don't lose the opportunity to share all of this next summer at LSM '97.



Victor E. Gebauer
Executive Director
Lutheran Music Program, Inc.

Victor E. Gebauer

Dear Student Musicians,

We are looking forward to LSM'97 with great anticipation. The new Center for the Arts facility at Valparaiso University will offer an exciting venue for us this summer. If you are interested in joining us this summer, or have any questions or concerns, please call me at 612/879-9555. Together, we can find the solution to any obstacles you may have. Join us and grow musically, spiritually, and emotionally to new heights!

Melissa Olson

Melissa Olson
Director of Admissions

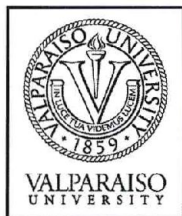

Dear Friend,

Valparaiso University is eagerly anticipating being the host institution for LSM'97. This will be the first time that LSM campers and staff will use the wonderful facilities in the new Valparaiso University Center for the Arts.

LSM'97 will be a wonderful experience for you. We all look forward to greeting you and your fellow campers as you come to Valparaiso.

Alan Harre

Alan Harre, President
Valparaiso University

4 Studying and Performing

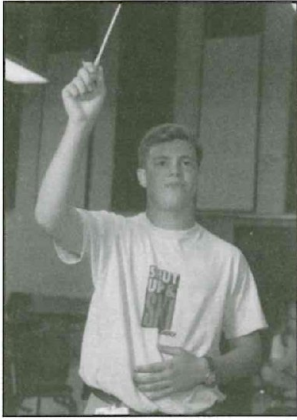

Lutheran Summer Music offers a rewarding immersion in required and optional musical activities.

Concerts and Recitals—Participation in or attendance at all musical performances at camp is required as fundamental to the study and enjoyment of music of all periods and styles.

Lessons—Individual instruction is offered on all orchestral and band instruments, voice, piano, and organ. All students take two 25-minute lessons each week in their first instrument or in voice. In addition, many students choose to take 1 or 2 optional lessons per week in a second instrument or in voice.

Small Ensembles—Small musical ensembles are a hallmark of the music camp. All students belong to chamber ensembles (string quartets, brass and woodwind quintets, keyboard and vocal ensembles, etc.) at appropriate levels of advancement as determined by auditions and subsequent progress. Ensembles normally rehearse several days each week.

Large Ensembles—All students (including pianists and organists) are assigned to concert choir, symphony orchestra, concert band, string ensemble, wind ensemble or flute choir as determined by auditions. While every effort will be made to honor student preferences for ensembles, placement is determined by auditions, schedules, and ensemble requirements. Large groups meet five times per week.

Optional Ensembles—*Jazz Ensemble*, *Handbell Ensemble*, and *Collegium Musicum* are elective options. Each group rehearses two or three times per week.

Music Listening and Musicianship—To develop musicianship and musical perspective, all students study works of great composers and principles of musicianship. Placement tests will determine listening and musicianship section assignments. Advanced students may elect composition class. Music listening meets twice and musicianship three times each week.

Enrichment Areas—Enrichment Areas provide a broadened artistic experience in a workshop setting. Students may select an area based on their interest and previous experience from among the following: musical theatre, drama, dance, and art. Specific offerings depend on registration. Classes meet three times per week.

Worship and Church Music—Worship provides a natural outlet for the performance of music by Christians. Campers learn much about church music just by participating in daily worship, and for many, by singing in the Chapel Choir. Classes in church music, hymnody, and worship planning are offered three times weekly for those who want to learn more about music leadership in church.

Conducting—Instruction in conducting instrumental and vocal ensembles is offered optionally in two classes each week.

Concerto Performance Auditions — All wind, string, and keyboard instrumentalists accepted as students in the camp are eligible to audition without extra charge for a performance with the LSM Orchestra during the concluding Festival of the camp. To enter, students must submit a separate audition tape (received by LMP by June 1), which is to be a movement of a concerto chosen from the standard repertoire. Finalists for the live audition at camp will be selected from the tape auditions. Write for more information and an entry form or check item No. 14 on page 11.

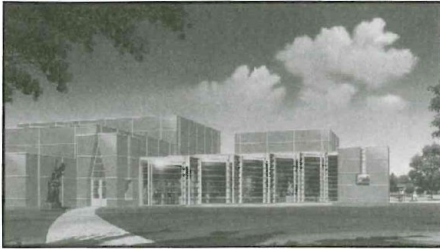

Campus—LSM'97 will be held on the campus of Valparaiso University in Valparaiso, Indiana. Valparaiso is a traditional residential city of about 25,000 conveniently located about 60 miles south-east of Chicago on US30 and just off Interstates 65, 80, 90, and 94. We are looking forward to being at Valpo and enjoying its new \$20 million Center for the Arts.

Housing and Meals—Students, counselors, faculty, and staff live as a community on campus. Students are housed in double rooms in modern dormitories with linen and towel service and laundry facilities. Attractive, nutritionally balanced meals are served cafeteria style. Some medically approved diets may be available under special circumstances. Food preparation is not allowed in the living quarters.

Counseling—The Chaplain, the Dean of Students, and adult Christian dormitory counselors are available to assist students to make the most of the many opportunities for personal and musical growth and for individual counseling when needed. All teachers stand ready to assist students in matters relating to their musical progress.

Worship—Christian worship is at the heart of camp life. All campers are expected to participate in daily opportunities to grow spiritually and culturally through worship as a part of the basic curriculum. They will enjoy faculty and student musical participation at Evening Prayer and Sunday services, as well as brief *Abendmusik* performances that precede worship.

Social Life and Recreation—The camp offers daily opportunities to enjoy healthful recreation and an active social life.

Programs, parties, and dances are scheduled regularly. Both supervised and free recreation are offered. Available activities include swimming, basketball, running, volleyball, softball, tennis, aerobics, and weights.

Health Service—Professional health service is available on a daily basis. Arrangements are made with local hospitals to provide emergency services.

Camp Regulations—Christian behavior is expected of all students admitted into the program. They are to abide by the code of appropriate conduct and dress that has been adopted for the welfare and benefit of all campers. Admitted students will be sent the "LSM Handbook" outlining camp expectations and regulations. In brief: 1. Students may not possess or use alcoholic beverages, tobacco, weapons, or unauthorized drugs; inappropriate sexual activity is not acceptable. 2. Modest and neat summer sports clothes are considered appropriate. 3. Students may not leave the camp without permission. 4. Automobiles and motorcycles are not to be operated by students during the camp; in-line skates are prohibited; bicycles are not needed. 5. Visitors are always welcome at LSM but they must register at the camp office upon arrival. Student schedules must not be interrupted. 6. A dress code is observed at all concerts, recitals, and worship.



6 Past Faculty Leadership



Lori Everson

Artist teachers and directors provide strong nurturing leadership at Lutheran Summer Music. 1996 faculty included:

Trudi Anderson, Augsburg College, Minneapolis, MN, *flute*
Brian Barclay, Brooklyn, NY, *piano*

Paul Bouman, Oak Park, IL, *Chapel choir, voice*

Christopher Cock, Valparaiso University, Valparaiso, IN, *choir*

Michael Chesher, Luther College, Decorah, IA
John Cheek, Concordia College, Bronxville, NY, *piano*
S. Blake Duncan, Bradley University, Peoria, IL, *oboe*
Lori Everson, Lexington, KY, *violin*

Terry Everson, University of KY, *trumpet*

David Eaton, Kansas, *music literature*

Dennis Friesen-Carper, Valparaiso University, Valparaiso, IN, *composition*

Allen French, University of NE, *french horn*

Ed Gant, Decorah, IA, *cello*

Diana Gannett, Iowa City, IA, *string bass*

Sarah Hersh, Minneapolis, MN, *violin*

Carol Hester, Luther College, Decorah, IA, *conductor*

Jon Jones, Columbus, OH, *percussion*

Vicki Johnson, Luther College, Decorah, IA, *piano*

Martin Jean, Valparaiso University, Valparaiso, IN, *organ*

James Klein, CA State University-Stanislaus, Turlock, CA, *conductor*

Peter Lingen, Luther College, Decorah, IA, *guitar*

David Mennicke, Concordia College, St. Paul, MN, *voice*

Anna Mooy, Bemidji State University, Bemidji, MN, *voice*

Paul Morton, Bemidji State University, Bemidji, MN, *trumpet*

R. Greg Morton, Cedar Rapids, IA, *bassoon, saxophone*

Victor Matfield, City University of NY, Staten Island, NY, *collegium musicum*

David Neely, University of NE, Lincoln, NE, *violin*

Elinor Niemisto, St. Olaf College, Northfield, MN, *harp*

Fred Nylene, Luther College, Decorah, IA, *conductor*

Sandra Peter, Luther College, Decorah, IA, *voice*

Clark Potter, University of NE, Lincoln, NE, *viola/violin*

James Ramlet, Golden Valley, MN, *voice*

Shari Speer, St. Paul, MN, *voice*

Robert Satterlee, Augustana College, Rock Island, IL, *piano*

Rändel Wolfe, Trinity Evangelical Lutheran Church,

Lawrence, KS, conductor, *chapel choir*

George Work, IA State University, Ames, IA, *cello*

Kevin Wass, Omaha, NE, *Low brass*

Esther Wang, University of WI, Platteville, WI, *piano*

Larry Zimmerman, Minneapolis/St. Paul, MN, *trombone*

Camp Administration

Victor E. Gebauer, Lincoln, NE, Executive Director

Jeffrey Doebler, Valparaiso, IN, Summer Program Director

Jon Jones, Columbus, OH, Assistant Summer Program Director-Enterprises

David Freudenburg, Flushing, NY, Assistant Summer Program Director-Concert Events



Jeff Doebler

A staff of trained musician counselors provide guidance and assistance for all campers.

Other outstanding Faculty Artists Over the Years

Since the founding of Lutheran Summer Music in 1982, distinguished teachers and directors from across America have set high standards for quality of instruction and performance as well as personal concern for students. The LSM faculty of past years has included:

Steven Amundson, St. Olaf College, *orchestra*

Gary Bordner, St. Paul Chamber Orchestra, *trumpet*

Donald Busarow, Wittenberg University, *organ, composition*

Frederick Fennell, Miami, FL, *band*

Kirkland Ferris, Minnesota Orchestra, *bassoon*

Philip Gehring, Valparaiso University, *organ, composition*

Charles Gray, St. Olaf College, *violin/viola*

Craig Johnson, University of TX, *choir, voice*

Katherine Borst Jones, OH State University, *flute*

Daniel Moe, Oberlin Conservatory, *choir*

Weston Noble, Luther College, *band, choir*

Russell Pesola, Concordia College-Moorhead, *band*

Dale Warland, Dale Warland Singers, *choir*

A. DeWayne Wee, St. Olaf College, *piano*





SPECIAL MOMENTS AT LSM

Guest Artists—Many guest artists have illuminated the stage of Lutheran Summer Music, both in concerts and in master classes with students:

Dallas Brass, Dallas, TX

Ruebén González, Associate Concertmaster, Chicago Symphony Orchestra, *violin*

Irene Gubrud, 1980 Naumberg International Voice Competition Winner, *soprano*

Elizabeth Holoque, Metropolitan Opera

Theodore Lettvin, University of Michigan, *piano*

Daniel McKelway, 1984 Young Concert Artists International Winner, *clarinet*

Paul Manz, Chicago, *organ*

André-Michel Schub, Naumberg International, Avery Fisher, and Van Cliburn winner, *piano*

William Scarlett, Assistant Principal, Chicago Symphony Orchestra, *trumpet*

Philip Smith, Principal, New York Phil, *trumpet*.



Special Events-1997

Lutheran College Fair

An evening at camp for students to get acquainted with the musical and other educational offerings of a score of Lutheran colleges—an excellent opportunity for personal interaction with college admissions counselors or musicians.

Music-Drama-Art Caravan

(dates to be announced)

An excursion for students to sample briefly the rich cultural life within the region. Admission to museums, concerts, or plays will be arranged as available.

“Sounds of Summer” Festival

July 14-20

The ideal time for guests to visit the camp is during the culminating “Sounds of Summer” Festival with its many concerts, recitals, displays, and worship services, which are held at Valparaiso University.

Information about special event tickets, schedules, housing, and meals is available from the Lutheran Music Program office:

(612) 879-9555 (before June 13) or (219) 464-6923 (after June 13).

8 The Story of Lutheran Music Program

Fifteen years ago a group of visionary Lutheran educators and musicians conceived a program of high quality in music that would encourage youth of high school age to develop their God-given talents and to strengthen and extend the Christian tradition of fine musical performance in worship.

Aid Association for Lutherans (AAL) supported a 1981 feasibility study that confirmed the strength of the concept. With seed money from AAL, an independent policy-making board of directors was formed and an executive director, Dr. Carlos R. Messerli, engaged.

Month-long Lutheran Summer Music camps have been held annually since 1982 on various college or university campuses: St. Olaf (MN); Valparaiso (IN); Luther (IA); Wittenberg (OH); Augustana (IL); Concordia-Moorhead (MN); Augustana (SD)

LSM now annually attracts well over 230 students from nearly 40 states and several foreign countries. The program is supported by fees from participants, grants from organizations and donations from many congregations and individuals who especially recognize the need for funds for scholarships and financial aid for worthy students.

LUTHERAN MUSIC PROGRAM BOARD OF DIRECTORS

Mr. Raymond Avischious, President, Colorado Springs, CO
The Rev. Dr. August Bernthal, Vice President, Winter Haven, FL
Mr. Dieter Nickel, Treasurer, Merrill, WI
Mrs. Darlene Swanson, Secretary, Omaha, NE
Mr. Gary Aamodt, Minneapolis, MN
The Rev. Paul Bartling, Seattle, WA
Mrs. Phyllis Duesenbeg, St. Louis, MO

Dr. Arvin Hahn, Zionsville, IN
The Rev. Victor O. Mennicke, Sarasota, FL
Mrs. Ewald H. Mueller, retired member, St. Louis, MO
The Rev. Dr. David Preus, Minneapolis, MN
Dr. Carl F. Schalk, Melrose Park, IL
Col. William Seeber, Valparaiso, IN
Dr. Frederick H. Telschow, Valparaiso, IN

“What others have said...”

“The growth of the students in their gifts and abilities each year amazes me, as does the commitment of the faculty and staff to providing a caring and supportive environment that demands excellence of everyone at the camp, without putting the sort of undue pressure on any student that would discourage them...a program that is uniquely positioned to nurture students in their abilities...”

-Prof. Terry Everson, trumpet, University of Kentucky; winner of three international trumpet competitions; LSM faculty

“There is not a June or July that has gone by that I haven’t paused at least once and thought of all those students gathering to sing and play their hearts out! Friends I made at LSM have continued to remain dearest and closest to me. Through the years, even though distance has separated us, music and a common faith have held us together.”

-LSM alumna, currently a volunteer missionary in South America teaching Paraguayan church musicians



“Lutheran Music Program helps to foster in young people an understanding of classical music and historic worship forms and how the two can commingle. A great experience for young musicians!”

-Prof. Martin Jean, Valparaiso University organist; 1992 winner, National Young Artist Competition in Organ Performance sponsored by the AGO; LSM faculty

“Of the three music camps I have been to, this is the best because of the level of intensity, the wonderful faculty, and the Christian atmosphere... The faculty is the best of the best. I enjoy the evening service immensely. It is the perfect way to end the day.”

-former LSM camper from Sarasota, Florida



Preference in admission is given to those students of high musical ability who have demonstrated a lively interest in the affairs of their church and school and who have the capacity to work well with other students and adults. Total enrollment will be limited and admission quotas have also been set for each vocal and instrumental area to achieve the best program for all who are admitted and to maintain a balance of ensemble membership. Some quotas are filled early. To receive full consideration for both acceptance and financial assistance, applications must be mailed to Lutheran Music Program by **June 1. Preference will be given to the earliest and most qualified applicants.**

As soon as an application (including the tape audition) has been evaluated, a letter of acceptance or non-acceptance will be sent. If a student is not accepted, an **alternate status** may be assigned pending subsequent openings. A student may be admitted conditionally when the quota for the student's "first" instrument (or voice) has been filled or when audition tape performance suggests difficulty in meeting camp standards.

All fees deposited will be returned to alternates if they have not been accepted as students. An applicant accepted conditionally who does not wish to attend camp under the conditions offered by the Program may obtain a full refund by submitting a letter of withdrawal.

Application Procedure

To be considered for admission, an applicant must mail all of the following items by June 1:

1. Complete **application form** signed by **both** student and parent or guardian (all students).
2. Payment of \$100 **First Installment**; see p. 10 (all students).
3. **Cassette tape recording(s)**; see following information (all students). **Note:** personal musical auditions will also be given each student upon arrival at camp.
4. A **musical recommendation** from a music teacher or director regarding the student's ability to profit from intensive individual music study and group performance (new students only).
5. A **personal recommendation** from a pastor, adult leader or teacher (in a non-music area) evaluating the student's maturity and ability to adjust to the requirements of living in a month-long summer camp environment (new students only).

Note: Applicants should send in items 1 & 2 even if items 3, 4, and 5 will be delayed.

*Less experienced singers, auditioning for ensemble only, may submit a simplified voice tape which includes: a. One-octave scales (one high, one low) sung on "lah," b. a hymn melody (with accompaniment), c. a hymn voice-part that is not the melody (with accompaniment).

Tape Audition Information

1. All students must submit with their applications a **separate** cassette tape of performance on **each** instrument (or voice) offered for either lessons or for ensemble membership. **Note:** Keyboard students are expected to participate in a large ensemble; therefore (for placement purposes only) they must submit a second tape in voice or in another instrument.*
2. Each recording should not exceed 15 minutes.
3. Music to be performed is the choice of the student, but the following should be included to the extent possible:
 - a. Scales, exercises, or vocalises
 - b. One or two (accompanied if possible) solo compositions (or hymn melodies) **and/or**
 - c. unaccompanied excerpts of orchestra, band, or chorus parts, or hymn voice-parts (except piano, organ, or guitar)
4. When recording, the student should clearly announce: a) his or her name, b) name of exercise or composition, c) name of composer.
5. Each cassette and cassette container must be labeled with student's name and address, name of instrument or voice, and list of pieces performed.

Mailing Address

Before June 13
Lutheran Music Program, Inc.
122 W. Franklin Avenue, Suite #522
Minneapolis, MN 55404
Phone: (612) 879-9555

From June 13 through July 25
Lutheran Music Program, Inc.
Valparaiso University
Valparaiso, IN 46383
Phone (219) 464-6923

10 Fees



The actual cost of offering Lutheran Summer Music-1997 will be over \$2900 per student. A subsidy of \$1,060 from generous donors reduces this amount to the Program Fee of \$1,740.

The Program Fee includes tuition for most classes, lessons in one instrument or voice, rehearsals, admission to performances, meals, a shared dormitory room, and use of campus recreational facilities. It does not include personal spending money, fee for optional enrichment area or additional lessons, transportation to or from campus, off-campus excursion costs, or required group emergency health and accident insurance.

Program Fee – \$1,740.00

LSM Alumni - Application postmarked by Jan. 15	(SAVE \$140)	\$1,600.00
New Students - Application postmarked by Jan. 15	(SAVE \$120)	\$1,620.00
All Students - Application postmarked by March 15	(SAVE \$100)	\$1,640.00
All Students - Application postmarked by May 1	(SAVE \$50)	\$1,690.00
All Students - Application postmarked after May 1		\$1,740.00

Program Fee – Schedule of Payments:

First Installment of the Program Fee must accompany all applications. (In case of cancellation by the student, \$50 of this fee is non-refundable. For refund, written notice of cancellation must be received before May 15.) **\$100.00**

Second Installment of the Program Fee must be paid by March 1 OR within one week following notification of a) acceptance, OR b) the financial aid award, whichever is later. This installment is non-refundable if the student subsequently cancels except in case of verified medical emergency of the student. Written notice of cancellation must be received before June 10. **\$300.00**

Third Installment of the Program Fee must be paid a) by May 1 OR b) within one month following the due date of the Second Installment, whichever is later **\$300.00**

Final Installment is payable no later than the student's June 22 arrival at camp. It will include the unpaid remainder of the Program Fee in addition to the other fees listed below. This total may be reduced by 1) any LMP financial aid for which the student has qualified and 2) any funds that have been received by LMP from sponsors contacted by the student (see "Financial Aid Information" Booklet, available upon request). Registration will be expedited for those students who have paid their fees by June 1.

Other Fees:

Required

Refundable badge and property damage deposit	\$20.00
Instrument Deposit	\$25.00
Group emergency health and accident insurance	\$8.00
Music-Drama-Art Caravan	\$45.00

Optional

Enrichment Areas	\$35.00
Optional Ensembles (Jazz Ensemble, Handbell Ensemble, Collegium Musicum).....	\$10.00
Lessons on second instrument or voice	
8 twenty-five minute lessons	\$120.00
4 twenty-five minute lessons	\$60.00
Shuttle (arrival or departure)	
Air, Chicago, IL	
Amtrak, Chicago, IL	<i>(based on extent of service)</i>

If a student qualifies for an early application discount and/or a scholarship or grant-in-aid (other than a transportation grant) from Lutheran Music Program, Inc., the balance owed by the student is the Program Fee less the discount and/or the amount of aid awarded. The balance may be paid by any combination of student and sponsor funds.

Overpayment of the Program Fee will be applied to other fees. Any remaining overpayment will be refunded after the close of camp.

Make checks payable in U.S. funds to "Lutheran Music Program." Please do not send cash. It is the responsibility of the student's parent/guardian to ensure that all fees are fully paid (from family or outside resources) by the time of registration or, if that is not possible, to arrange for and submit to LMP a deferred payment contract signed by them by the time the student arrives at camp. No deductions or refunds are made for late arrival, early departure, or in case of disciplinary separation of the student from the program.

Early arrival or late departure are not permitted, except by special arrangement with the Director of Admissions.



Student Application-LSM '97 11

(Please print or type)

Application deadline: June 1, 1997

1. Full name _____ Phone(____) _____
(first) (middle initial) (last)

2. Address _____ Date of birth _____
City _____ State _____ ZIP _____ Sex _____ Age _____

3. High School class _____ Other _____ Circle Yrs. attended LSM: Other _____
March 1997: (circle) Fr. So. Jr. Sr. (specify) '93 '94 '95 '96 (specify) _____

4. Name of school _____ Phone (____) _____
Address _____
(Street) (City) (State) (ZIP)

5. Congregation _____ Denomination _____ Synod/Church Body _____
Address _____
(Street) (City) (State) (ZIP)

Father, Stepfather, Guardian Mother, Stepmother, Guardian

6. _____ Name _____
Name

7. _____ Home address _____
Home address

8. _____ Occupation/Title _____
Occupation/Title

9. _____ Name of firm _____
Name of firm

10. (____) _____ (____) _____
Work phone Work phone

MUSIC STUDENT (Read p.4 "Studying & Performing," then give information on each numbered line below, check boxes, fill in blanks):

11. First instrument or voice classification _____ Years studied _____

12. Second instrument or voice classification _____ Years studied _____

13. (for lessons at extra cost for ensemble membership)

14. Send me information and entry form for Concerto Performance Auditions.
Entry form and separate Concerto Audition tape due June 1.

15. I am not applying for financial assistance from LMP.

16. I am applying for financial assistance from LMP. My application for financial aid is enclosed.
(LMP Incentive Grants are awarded only to those who apply and qualify for aid.)

17. I hereby apply for AAL Member Scholarship. Applicant's Certificate # _____

18. I am applying as an Intern (LSM alumni only - min. college fresh. yr. completed)

If accepted as a student, I agree to abide by Lutheran Music Program, Inc., regulations and to cooperate with camp authorities in furthering the ideals of the Program. I agree not to possess or use alcoholic beverages, tobacco, unauthorized drugs, or weapons, or engage in inappropriate sexual activity while a student in the Program. I agree to remain a student for the entire session unless prevented by reasons beyond my control. I understand that no deductions or refunds of the Program Fee and other fees will be made for late arrival, early departure, or expulsion for disciplinary reasons. I agree to fulfill my obligation for full payment of my account. I give my approval to record and broadcast performances in which I participate and which have been deemed appropriate by camp authorities.

(signature of parent or guardian required)

and

(signature of applicant required)



Reminder - No application will be considered until the following are received:

All Students-

Audition tape(s)

\$100 First Installment

New Students must also send-

Personal Recommendation

Musical Recommendation

Lutheran Music Program, Inc., does not discriminate on the basis of race, color, disability, or national or ethnic origin.

Lutheran Summer Music Is Affordable!

For those who need financial assistance to attend camp, several types of aid are available.

- Incentive Grants of up to \$200 from Lutheran Music Program
- Local Matching Grants of up to \$600 from student-secured sponsors



Plan to Attend:
"Sounds of Summer"
Festival
July 14-20
Valparaiso University
Valparaiso, Indiana

- AAL Member Scholarships of \$450 for all AAL Certificate holders
- Other LMP scholarships and grants
 - for students demonstrating financial need
 - for students needed to achieve ensemble balance
- Transportation Grants for students with high travel costs

For details see "Financial Aid Information" available on request.

Lutheran Music Program
122 W. Franklin Ave., Suite #522
Minneapolis, MN 55404

NON-PROFIT ORG.
PAID
PERMIT NO. 27037
Mpls MN